

# Table 4 Typical Bar Bends

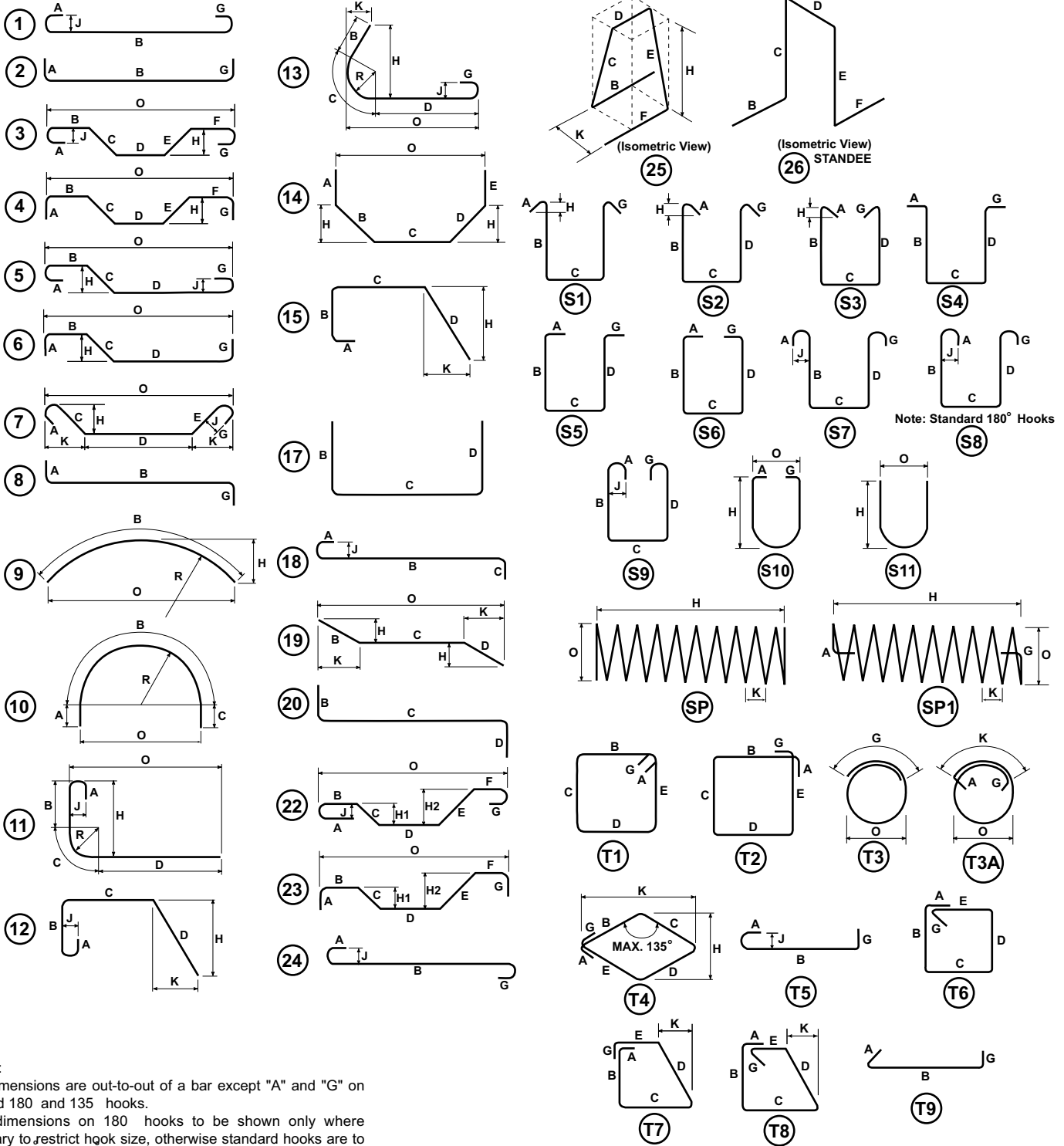

**NOTES:**

1. All dimensions are out-to-out of a bar except "A" and "G" on standard 180 and 135 hooks.
2. "J" dimensions on 180 hooks to be shown only where necessary to restrict hook size, otherwise standard hooks are to be used.
3. On Truss bars "J" will be kept equal to or less than "H". Where "J" can exceed "H" it should be shown.
4. On stirrups "H" dimension should be shown only where necessary to fit within concrete.
5. Critical dimensions are to be identified where bars are to be bent more accurately than standard bending tolerance.
6. On type T3 "G" dimension is equal to Class B splice.
7. Figures shown in circles show types.
8. All bar bends other than the types shown above must be designated as type "X".



REINFORCING STEEL  
INSTITUTE OF CANADA  
INSTITUT D'ACIER  
D'ARMATURE DU CANADA  
PO BOX 40620  
RPO Six Points Plaza  
Toronto, Ontario M9B 6K8  
(416) 239-RSIO (7746)

Unless otherwise noted diameter "D" is the same for all bends and hooks on a bar.

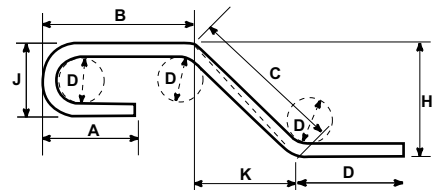

ENLARGED VIEW SHOWING BAR BENDING DETAILS